

ZLOG Series

Multiple Use Temperature & Humidity Data Logger



1、Configuration Parameters

Connect the ZLOG series data logger to the computer USB port, at this time in the computer desktop will display a FRESVUEDISK mobile disk icon. Type www.fresvuelogger.com in your web browser to open the online configuration site, then select the product model currently in use, then enter the required configuration parameters and click Generate Configuration File, at which time the browser will download a configuration file with a .cfg suffix.

Copy the configuration file (.cfg suffix) to the mobile disk drive of FRESVUEDISK, at this time, if the configuration is successful, the display will show ConF, if other information is displayed, it may be an error in the configuration file, specifically refer to the error code analysis.

NOTE: Do not disconnect the product from the computer until ConF is displayed on the top of the product's LCD screen!



Error codes (in case of misconfiguration, an error code will be displayed on the product LCD screen)



Error Code	Code Resolution	Step
E001	CFG File validation failure	Copy the correct CFG file
E002	Inconsistent equipment models	Confirmation of equipment model
E003	Inconsistent device firmware versions	Verify that there are no errors in the product firmware
E004	Lost or wrong password	Confirm that the password is correct
E005	Too low a charge causes an error	Replacement of new batteries
E006	Incorrectly configured time for autostart	Confirm that the time is correct

LCD prompt after configuration



Manual start:

LCD display this character is waiting for manual start state, at this time you need to long press the START button for 3 seconds in order to start the record, long press the START button process, the screen will flash the character of go.



Timed start:

The LCD displays this character as a wait to automatically start the logger when the set start time is reached.

Start-up delay:

If the logger is configured with a startup delay, then after startup, the LCD will display the countdown time, as exemplified below (10m means 10 minutes of countdown time)

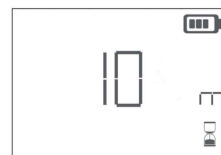

Note: In the startup delay, days are d, hours are h, minutes are m

2、Activation record

When the recorder formally enters the recording state, the LCD will display the REC icon as follows:



The following icons are displayed according to the configuration, the temperature value will be displayed for 10 seconds, after 10 seconds the value display will be extinguished and the other icons will not move to enter the recording standby state.

3、Overlimit Alarm

The recording process displays an X alarm icon if the temperature exceeds the alarm threshold and the alarm interval number, which is displayed as follows:



Note: When the logger sounds an alarm, the alarm remains even if the ambient temperature returns to the original zone.

4、View Recorded Data

To view the currently recorded statistics during recording, tap the VIEW button to toggle the statistics, which are displayed as follows:

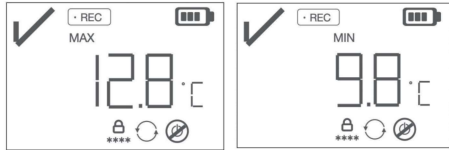

Maximum temperature Minimum temperature

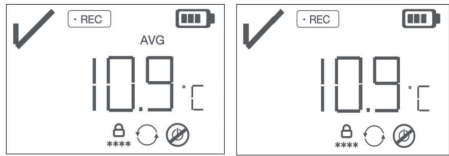

Average temperature Current temperature

5、Stop Recording

If the stop button is not prohibited, the recording can be stopped by long-pressing the STOP button, long-pressing the button for 3 seconds displays "Stop" and blinks, and after 3 seconds "Stop" is displayed, the button can be released, and the device is in the state of stopping operation at this time. The display is as follows:



6、Download Recorded Reports

Plug the recorder into the computer's USB port, the recorder displays "Pdf" on behalf of the start of PDF generation, followed by a display of the progress of the generation (0 ~ 100), after reaching 100, it means that the PDF generation is complete as shown below:

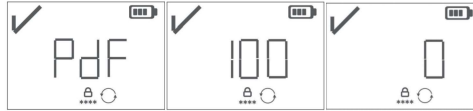

Once the report is generated, to the point where the screen displays USB, the report can be read, at which point a FRESVUEDISK removable disk icon will be displayed on the computer desktop.



7、Battery Replacement

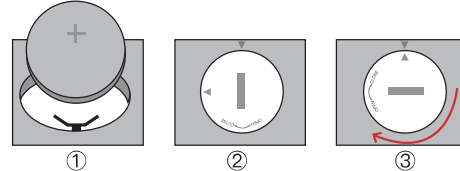

- Place a coin into the groove on top of the battery cover and open the battery cover counterclockwise in the OPEN direction to remove the old battery.
- Short press the START button until the LCD screen is all off, if it is not off into, the battery level can not be calibrated.
- Place a new CR2450 battery with the positive terminal facing upward diagonally against the Y-shaped tabs (as shown in Figure ①) into the device's battery compartment, do not press down on the Y-shaped tabs.
- Put the battery cover on (as shown in Fig. ②) and screw it clockwise in the direction of CLOSE until the arrows are aligned (as shown in Fig. ③).

8、LCD Screen

Full screen display

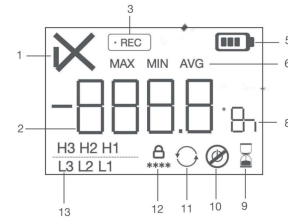

- Alarm status
- Temperature values, system information
- Record Status
- battery indicator
- Statistical information, maximum temperature, minimum temperature, average temperature
- Temperature in °C/F, time in d,h,m
- Startup delay marker
- Disable Push Button Stop Function
- Repeat start, long press the START button after a round of recording to restart recording
- Password protection, you need to enter the password when configuring to configure successfully
- Alarm intervals (H3, H2, H1, L3, L2, L1), beyond a certain interval, the number of the interval is displayed

9、Product Parameters

Indicator	Green (Recording, OK) , Red (Alarm)
Battery life	Up to 2 years (1 year storage / 1 year useful life) @25°C, 5 minutes logging interval
Operation Temperature	-30°C~70°C dry ice model -90°C~70°C(Probe only)
Measurement Accuracy	±0.5°C, @-10~40°C, ±0.8°C@-30~-10°C&40~70°C (±3%RH@20~80%RH,±4%RH@other)
Resolution	0.1°C (0.1%RH)
Alarm Limit	Up to 6 individually programmable alarm limits
Memory Space	Up to 33,000 points
Logging Interval	1 minute -24 hours optional, Default 5 minutes
Start Delay	0 minute -24 hours optional, Default 10 minutes
Start Mode	Manual/Auto start
Report Format	PDF/CSV/PDF&CSV(optional)
IP Grade	IP65
Battery Type	3.0V CR2450
Connection	USB2.0

Contact:
www.prosense.com.au
 1800 652 062
sales@prosense.com.au